



## MONTREUX CHAISE LOUNGE WHEELS INSTALLATION

**710175W**

**710175WPS**

**720232W**

**720275WPS**

Tools required:

Safety Glasses

(2) 9/16" Wrenches

Kit includes:

(2) Wheels

(4) Washers

(2) Bolts

(8) Nylon Bushings

(2) 1/4" Lock Nuts

The chaise lounge wheels are packed in a separate box within the chaise lounge carton.

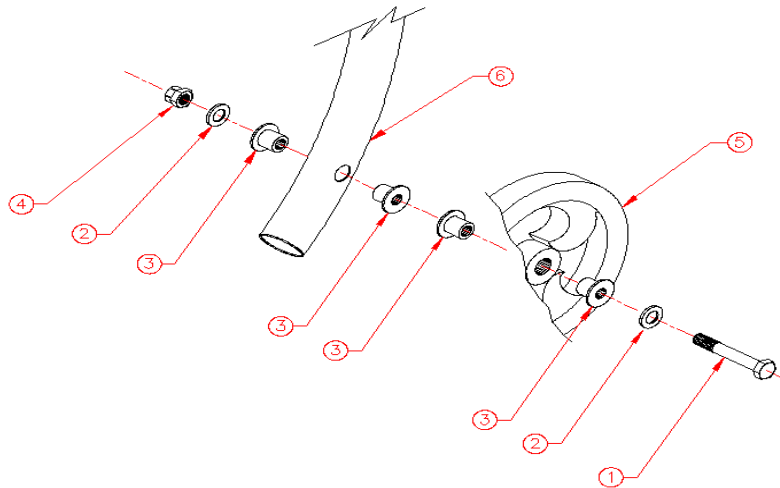

1. Place a Washer ② on the Bolt ① and add a Nylon Bushing ③.
2. Slide the Bolt assembly through the Wheel ⑤.
3. Add (2) Bushings ③ back-to-back.
4. Slide the Wheel assembly through the drilled hole in the chaise lounge frame ⑥.
5. Assemble the Bushing ③ and Washer ② onto the Bolt ①.
6. Hand thread the Locking Nut ④ onto the Bolt. Tighten with the wrenches, but do not overtighten and prevent the Wheel from turning. Test to ensure the Wheel rotates freely.
7. Repeat for other side of chaise lounge.